



# Single Prop 500 cm – MD Painted (Collar E/P – Nut D/F)

## Technical Data Sheets

Issue  
No.1

Date:  
30/08/2021

Control No.:  
TD-2021026

THE INFORMATION ON THIS DATA SHEET REMAINS THE PROPERTY OF SCAFFCO, AND IS NOT TO BE REPRODUCED WITHOUT WRITTEN PERMISSION. WE RESERVE THE RIGHT TO AMEND THIS DATA AT ANY TIME WITHOUT PRIOR NOTICE.

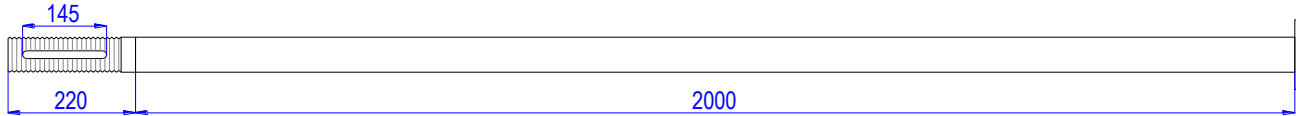

Outer Pipe

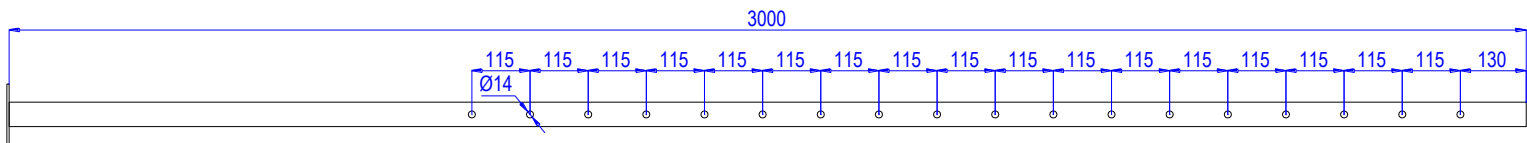

Inner Pipe

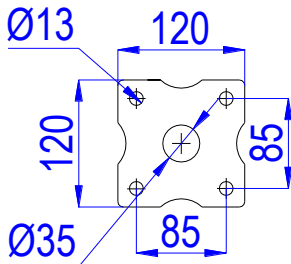

Top and Bottom  
Prop Plate

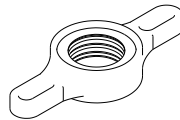

Prop Nut

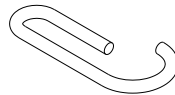

Prop Pin

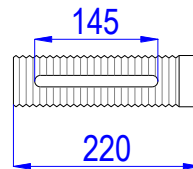

Prop Collar



## DESCRIPTION

Adjustable props are economical and popular instruments used to support concrete elements. They provide the best temporary support for all purposes. They are economical to hire or but, easier and quicker in erection that provides safe load supporting.

Specifications	
Outer Pipe Wall Thickness	2.00mm
Inner Pipe Wall Thickness	2.00mm
Pipe Material Finish	Painted
Approximate Weight	14.30 kg
Prop Collar Wall Thickness	3.00mm
Prop Collar Material	E/P
Prop Pin	Ø12mm
Plate Thickness	4.7mm
Nut Material	Drop Forge
Prop Height Adjustment	3.0m - 5.0m

©Scaffco

SCAFFCO FZCO  
P.O.BOX No: 18234  
JEBEL ALI FREE ZONE, DUBAI U.A.E  
TEL: +971 4 8862855  
FAX: +971 4 8862558  
EMAIL: info@scaffco.com



SCAFFOLDING CONSTRUCTION FACTORY- SCAFFCO L.L.C.  
P.O.BOX No: 41851  
ICAD I, MUSSAFAH, ABU DHABI U.A.E  
TEL: +971 2 5500688  
FAX: +971 2 5500689  
EMAIL: info@scaffco.com



SCAFFOLDING CONSTRUCTION COMPANY - SCAFFCO L.L.C.  
P.O.BOX No: 41851  
ICAD I, MUSSAFAH, ABU DHABI U.A.E  
TEL: +971 2 5500688  
FAX: +971 2 5500689  
EMAIL: info@scaffco.com